

Bleed Valves, Gauge Valves and Block & Bleed Valves

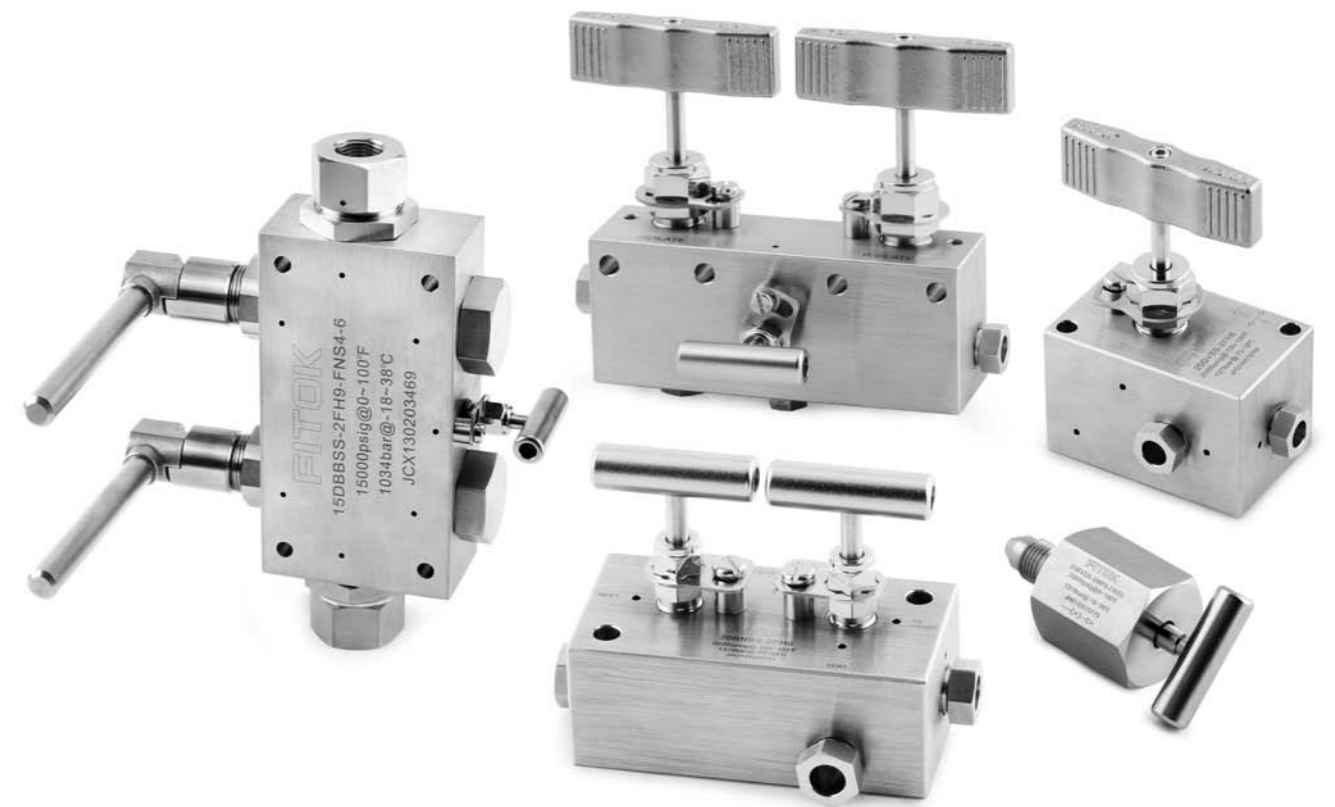

Contents

Bleed Valves

Pressures to 30,000 psi (2068 bar) 01

Gauge Valves

Pressures to 30,000 psi (2068 bar) 04

Block & Bleed Needle Valves

Pressures to 20,000 psi (1379 bar) 08

Double Block & Bleed Needle Valves

Pressures to 20,000 psi (1379 bar) 11

Double Block & Bleed Ball Valves

Pressures to 15,000 psi (1034 bar) 14

Bleed Valves

Pressures to 30,000 psi (2068 bar)

Features

- ⦿ One piece hex construction compact design allows easy installation.
- ⦿ Easy to assemble and replace O-ring.
- ⦿ Positive locking screw design prevents accidental removal of the stem.
- ⦿ Tee handle for easy operation.
- ⦿ Fluorocarbon FKM O-rings for operation from 0°F to 400°F (-17.8°C to 204°C).
- ⦿ 1/8" NPT outlet connection.

Standard Materials of Construction

| Item | Component | Material Grade/ASTM Specification |
|------|---------------|----------------------------------------|
| 1 | Handle Screw | Stainless steel |
| 2 | Handle | Stainless steel |
| 3 | Locking screw | Stainless steel |
| 4 | Body | 316 SS/A479 |
| 5 | Stem | S17400/A564 |
| 6 | O-ring | Fluorocarbon FKM |
| | Lubricant | Molybdenum disulfide/Fluorinated-based |

Note:

1. Special materials available on request. For the materials not shown above, please contact the authorized representative or FITOK Group.

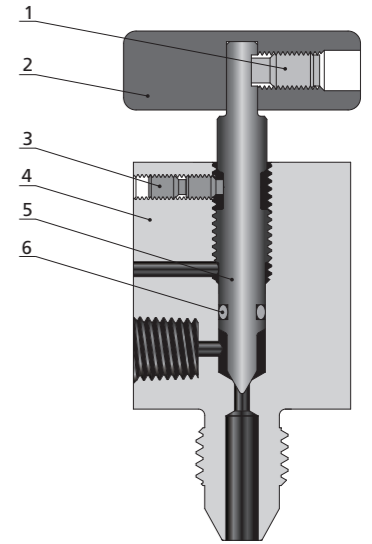

Technical Data

| Series | Connection Type (Inlet) | Orifice in. (mm) | Pressure @ Room Temperature psig (bar) |
|--------|-------------------------|------------------|----------------------------------------|
| 15BV | FM6 | 0.095 (2.4) | 15,000 (1034) |
| | FM8 | 0.095 (2.4) | 15,000 (1034) |
| | FM9 | 0.095 (2.4) | 15,000 (1034) |
| 20BV | 2MP6 | 0.095 (2.4) | 20,000 (1379) |
| | 2MP9 | 0.095 (2.4) | 20,000 (1379) |
| | 2CT6 | 0.095 (2.4) | 20,000 (1379) |
| | 2CT9 | 0.095 (2.4) | 20,000 (1379) |
| 30BV | 6MP6 | 0.095 (2.4) | 30,000 (2068) |
| | 6MP9 | 0.095 (2.4) | 30,000 (2068) |
| | 6CT6 | 0.095 (2.4) | 30,000 (2068) |
| | 6CT9 | 0.095 (2.4) | 30,000 (2068) |

Note:

A variety of end connections available on request. For connections not shown above, please contact the authorized representative or FITOK Group.

Dimensions

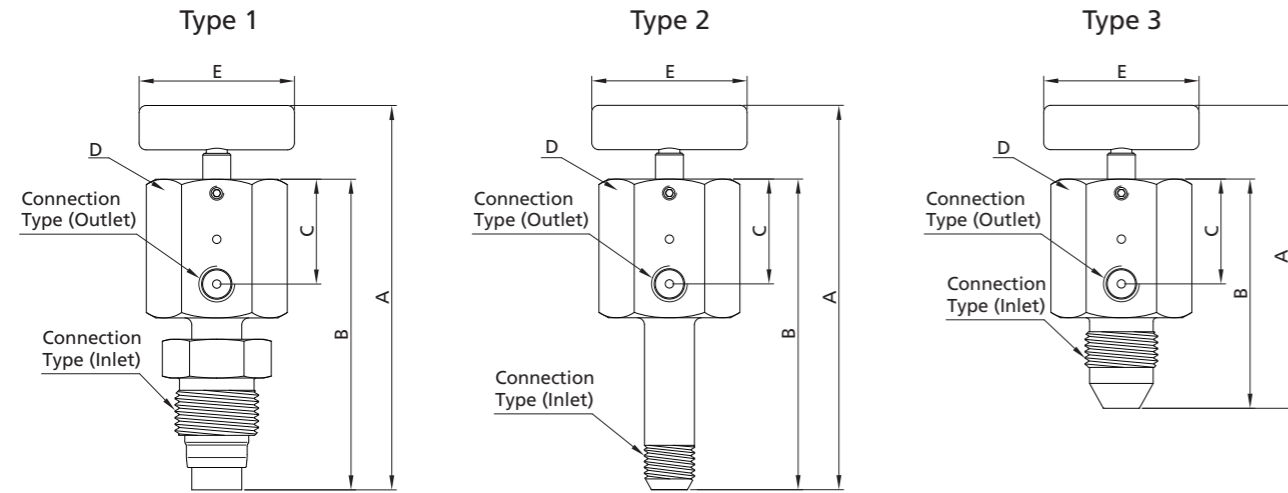

| Dimensions (Type 1) | | | | | | | | |
|---------------------|-------------------------|--------------------------|------------------|-------------|-------------|-------------|-------------|-------------|
| Ordering Number | Connection Type (Inlet) | Connection Type (Outlet) | Orifice in. (mm) | A | B | C | D | E |
| | | | | in. (mm) | | | | |
| 15BVSS-FM6-FNS2 | FM6 | FNS2 | 0.094 (2.4) | 3.69 (93.8) | 2.86 (72.7) | 1.18 (30.0) | 1.37 (34.9) | 1.75 (44.5) |
| 15BVSS-FM8-FNS2 | FM8 | FNS2 | 0.094 (2.4) | 3.80 (96.8) | 2.98 (75.7) | 1.18 (30.0) | 1.37 (34.9) | 1.75 (44.5) |
| 15BVSS-FM9-FNS2 | FM9 | FNS2 | 0.094 (2.4) | 4.33 (110) | 3.50 (88.9) | 1.18 (30.0) | 1.37 (34.9) | 1.75 (44.5) |

| Dimensions (Type 2) | | | | | | | | |
|---------------------|-------------------------|--------------------------|------------------|--------------|-------------|-------------|-------------|-------------|
| Ordering Number | Connection Type (Inlet) | Connection Type (Outlet) | Orifice in. (mm) | A | B | C | D | E |
| | | | | in. (mm) | | | | |
| 20BVSS-2CT6-FNS2 | 2CT6 | FNS2 | 0.094 (2.4) | 3.65 (92.6) | 2.81 (71.5) | 1.18 (30.0) | 1.37 (34.9) | 1.75 (44.5) |
| 20BVSS-2CT9-FNS2 | 2CT9 | FNS2 | 0.094 (2.4) | 3.93 (99.8) | 3.10 (78.7) | 1.18 (30.0) | 1.37 (34.9) | 1.75 (44.5) |
| 30BVSS-6CT6-FNS2 | 6CT6 | FNS2 | 0.094 (2.4) | 3.93 (99.8) | 3.10 (78.7) | 1.18 (30.0) | 1.37 (34.9) | 1.75 (44.5) |
| 30BVSS-6CT9-FNS2 | 6CT9 | FNS2 | 0.094 (2.4) | 4.38 (111.3) | 3.55 (90.2) | 1.18 (30.0) | 1.37 (34.9) | 1.75 (44.5) |

| Dimensions (Type 3) | | | | | | | | |
|---------------------|-------------------------|--------------------------|------------------|-------------|-------------|-------------|-------------|-------------|
| Ordering Number | Connection Type (Inlet) | Connection Type (Outlet) | Orifice in. (mm) | A | B | C | D | E |
| | | | | in. (mm) | | | | |
| 20BVSS-2MP6-FNS2 | 2MP6 | FNS2 | 0.094 (2.4) | 3.41 (86.7) | 2.58 (65.6) | 1.18 (30.0) | 1.37 (34.9) | 1.75 (44.5) |
| 20BVSS-2MP9-FNS2 | 2MP9 | FNS2 | 0.094 (2.4) | 3.41 (86.7) | 2.58 (65.6) | 1.18 (30.0) | 1.37 (34.9) | 1.75 (44.5) |
| 30BVSS-6MP6-FNS2 | 6MP6 | FNS2 | 0.094 (2.4) | 3.41 (86.7) | 2.58 (65.6) | 1.18 (30.0) | 1.37 (34.9) | 1.75 (44.5) |
| 30BVSS-6MP9-FNS2 | 6MP9 | FNS2 | 0.094 (2.4) | 3.41 (86.7) | 2.58 (65.6) | 1.18 (30.0) | 1.37 (34.9) | 1.75 (44.5) |

Note:
 1. D is the dimension of hex.
 2. A is the dimension of stem in closed position.
 3. All dimensions are for reference only and are subject to change. For dimensions not shown above, please contact the authorized representative or FITOK Group.

Part Number Description

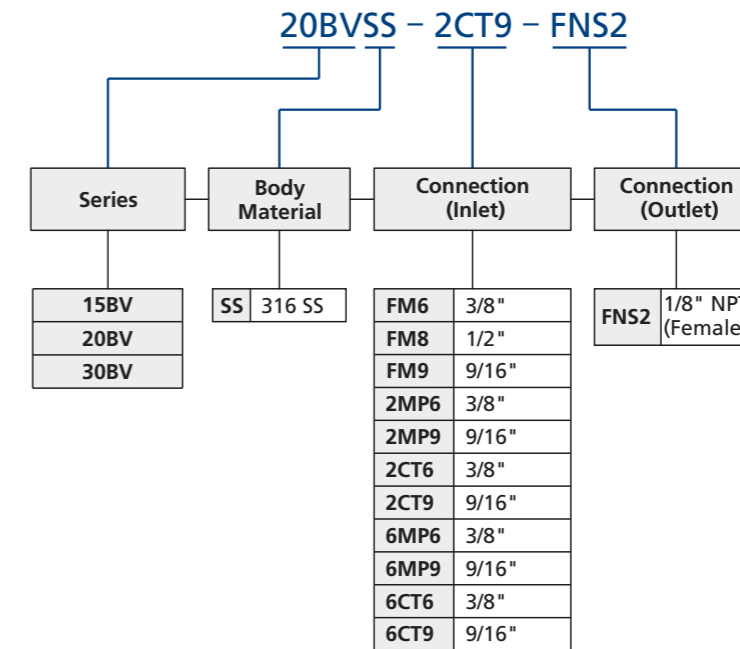

Note: "Part Number Description" is used for composition rules of FITOK product model, Not suitable for specific product part number selection, not random combinations. If in doubt, please contact FITOK group or authorized agent.

Gauge Valves

Pressures to 30,000 psi (2068 bar)

Features

- One inlet, three outlet ports.
- Metal-to-metal seating achieves ideal shutoff, longer stem/seat service lifetime for abrasive flow, excellent corrosion resistance and greater durability for repeated on/off cycles.
- PTFE is the standard packing material, RPTFE glass also available.
- The material of packing gland and upper stem have been selected to achieve reduced handle torque and extended thread cycle life.
- The location of packing is under the thread of valve stem.
- The locking device of packing gland is reliable.

Flow Data at 100°F (38°C)

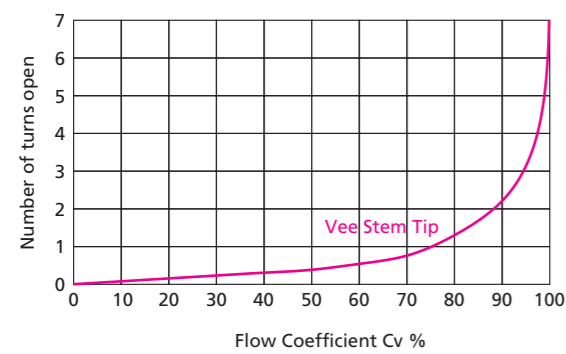

Pressure & Temperature

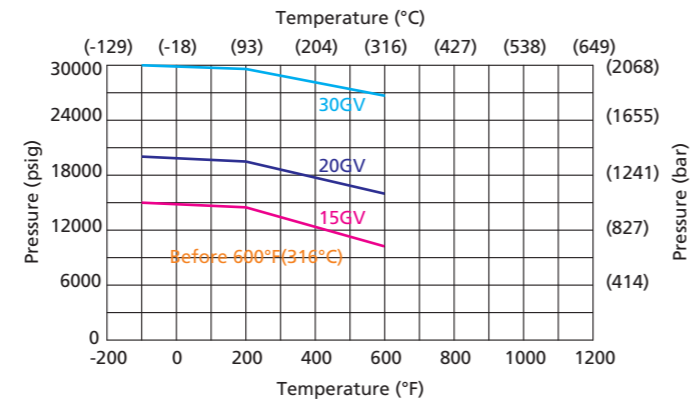

Technical Data

| Series | Connection Type | Orifice in. (mm) | Rated CV | Pressure @ Room Temperature psig (bar) |
|--------|-----------------|------------------|----------|----------------------------------------|
| 15GV | FH6 | 0.125 (3.18) | 0.23 | 15,000 (1034) |
| 20GV | 2FH6 | 0.125 (3.18) | 0.23 | 20,000 (1379) |
| | 2FH9 | 0.125 (3.18) | 0.23 | 20,000 (1379) |
| 30GV | 6FH6 | 0.125 (3.18) | 0.33 | 30,000 (2068) |
| | 6FH9 | 0.125 (3.18) | 0.33 | 30,000 (2068) |

Note:

- Extreme Temperatures**
PTFE is the standard packing material for FITOK Needle Valve; RPTFE glass also available.
Normal Needle Valve with PTFE packing can be operated to 450°F (232°C).
Normal Needle Valve with RPTFE glass packing can be operated to 600°F (316°C).
- A variety of end connections available on request. For connections not shown above, please contact the authorized representative or FITOK Group.

Standard Materials of Construction

| Item | Component | Material Grade/ASTM Specification |
|------|----------------|-----------------------------------|
| 1 | Handle | Stainless steel |
| 2 | Upper stem | 316 SS/A479 |
| 3 | Packing Gland | C63000/B150 |
| 4 | Lower Stem | 17-4PH/A564 |
| 5 | Packing Ring | C63000/B150 |
| 6 | Packing | PTFE/RPTFE |
| 7 | Packing washer | 17-4PH/A564 |
| 8 | Body | 316 SS/A479 |
| | Lubricant | Molybdenum disulfide |

Note:

- Special materials available on request. For the materials not shown above, please contact the authorized representative or FITOK Group.

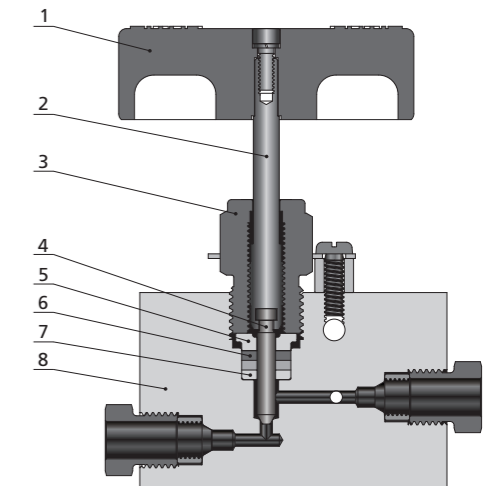

Dimensions

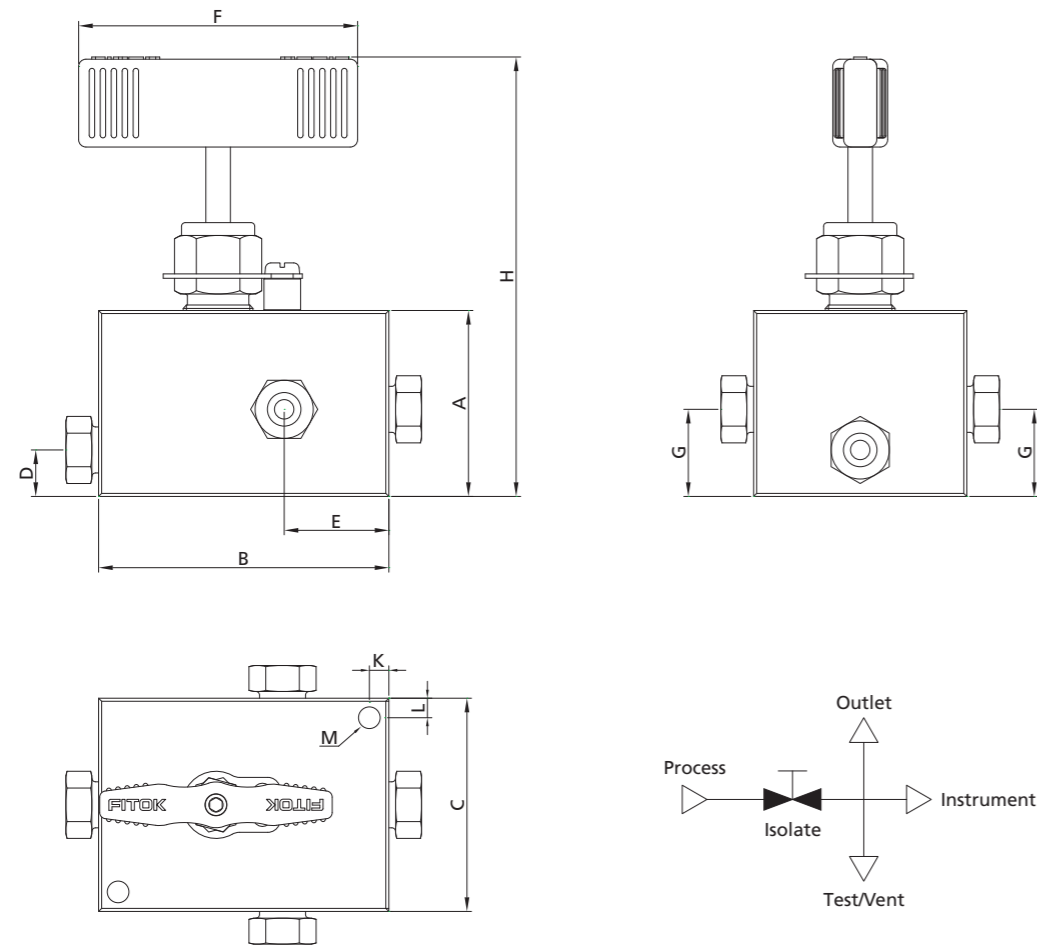

| Dimensions | | | | | | | | | | | | | |
|-----------------|-----------------|------------------|-------------|-------------|-------------|-------------|-------------|-------------|-------------|--------------|------------|------------|------------|
| Ordering Number | Connection Type | Orifice in. (mm) | A | B | C | D | E | F | G | H | K | L | M |
| | | | in. (mm) | | | | | | | | | | |
| 15GVSS-FH6 | FH6 | 0.125 (3.18) | 2.00 (50.8) | 3.12 (79.3) | 2.00 (50.8) | 0.50 (12.7) | 1.13 (28.6) | 3.00 (76.2) | 0.94 (23.8) | 4.68 (118.9) | 0.25 (6.4) | 0.25 (6.4) | 0.28 (7.1) |
| 20GVSS-2FH6 | 2FH6 | 0.125 (3.18) | 2.00 (50.8) | 3.12 (79.3) | 2.00 (50.8) | 0.50 (12.7) | 1.13 (28.6) | 3.00 (76.2) | 0.94 (23.8) | 4.68 (118.9) | 0.38 (9.7) | 0.25 (6.4) | 0.28 (7.1) |
| 20GVSS-2FH9 | 2FH9 | 0.125 (3.18) | 2.00 (50.8) | 3.88 (98.6) | 2.75 (69.9) | 0.66 (16.8) | 1.38 (34.9) | 3.00 (76.2) | 0.94 (23.8) | 4.68 (118.9) | 0.38 (9.7) | 0.38 (9.7) | 0.28 (7.1) |
| 30GVSS-6FH6 | 6FH6 | 0.125 (3.18) | 2.00 (50.8) | 3.12 (79.3) | 2.00 (50.8) | 0.50 (12.7) | 1.13 (28.6) | 3.00 (76.2) | 0.94 (23.8) | 4.68 (118.9) | 0.38 (9.7) | 0.38 (9.7) | 0.28 (7.1) |
| 30GVSS-6FH9 | 6FH9 | 0.125 (3.18) | 2.00 (50.8) | 3.88 (98.6) | 2.75 (69.9) | 0.66 (16.8) | 1.38 (34.9) | 3.00 (76.2) | 0.94 (23.8) | 4.68 (118.9) | 0.38 (9.7) | 0.38 (9.7) | 0.28 (7.1) |

Note:

1. M is the panel mounting drill size.
2. H is the dimension of stem in closed position.
3. All dimensions are for reference only and are subject to change. For dimensions not shown above, please contact the authorized representative or FITOK Group.

Part Number Description

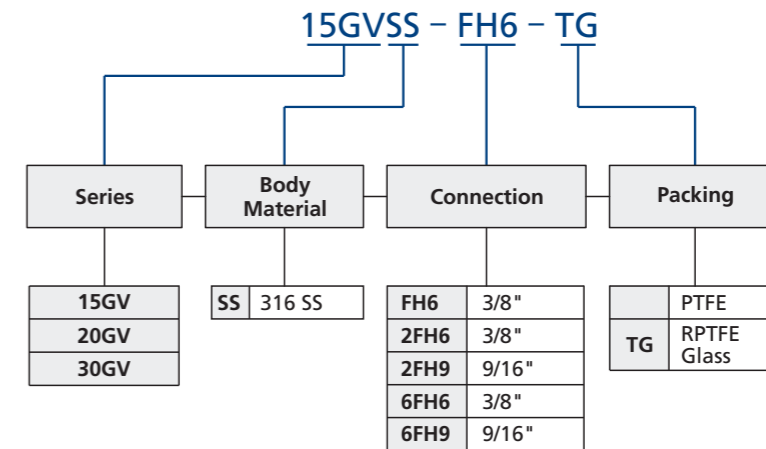

Note: "Part Number Description" is used for composition rules of FITOK product model, Not suitable for specific product part number selection, not random combinations. If in doubt, please contact FITOK group or authorized agent.

Block & Bleed Needle Valves

Pressures to 20,000 psi (1379 bar)

Features

- Compact design offers advantages over configurations with multiple valves and fittings.
- Minimal space needed for installation and operation.
- Cost savings from fewer components required.
- Reduced potential for leakage.
- Metal-to-metal seating achieves ideal shutoff, longer stem/seat service lifetime for abrasive flow, excellent corrosion resistance and greater durability for repeated on/off cycles.
- The material of packing gland and upper stem have been selected to achieve reduced handle torque and extended thread cycle life.
- The location of packing is under the thread of valve stem.
- The locking device of packing gland is reliable.

Flow Data at 100°F (38°C)

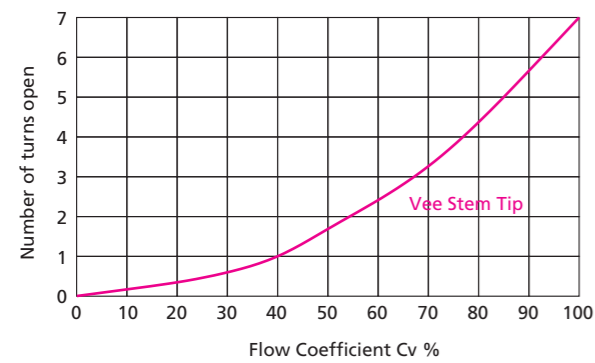

Pressure & Temperature

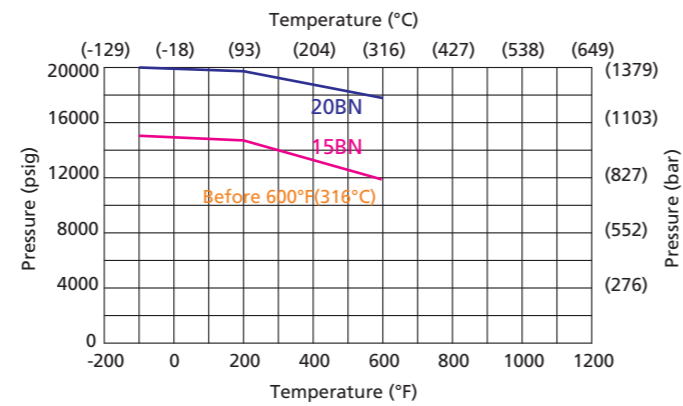

Technical Data

| Series | Connection Type | Orifice in. (mm) | Rated CV | Pressure @ Room Temperature psig (bar) |
|--------|-----------------|------------------|----------|----------------------------------------|
| 15BN | FNS4 | 0.093 (2.36) | 0.20 | 15,000 (1034) |
| | FNS6 | 0.093 (2.36) | 0.20 | 15,000 (1034) |
| 20BN | 2FH4 | 0.093 (2.36) | 0.20 | 20,000 (1379) |
| | 2FH6 | 0.093 (2.36) | 0.20 | 20,000 (1379) |

Note:

- Extreme Temperatures
 - PTFE is the standard packing material for FITOK Needle Valve; RPTFE glass also available.
 - Normal Needle Valve with PTFE packing can be operated to 450°F (232°C).
 - Normal Needle Valve with RPTFE glass packing can be operated to 600°F (316°C).
- A variety of end connections available on request. For connections not shown above, please contact the authorized representative or FITOK Group.

Standard Materials of Construction

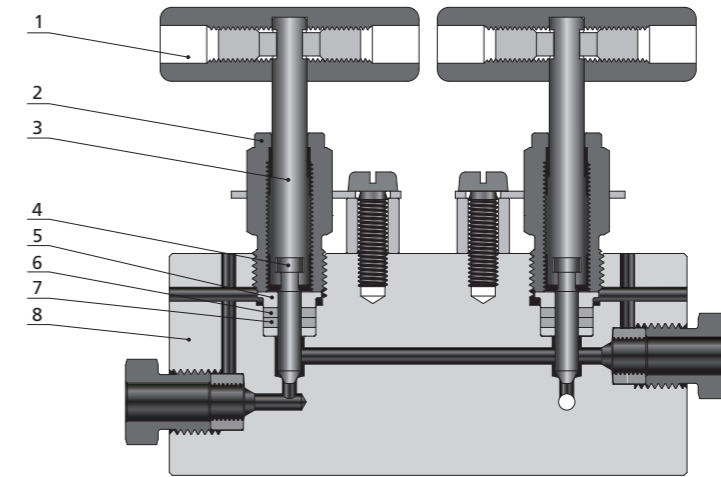

| Item | Component | Material Grade/ASTM Specification |
|------|----------------|-----------------------------------|
| 1 | Handle | Stainless steel |
| 2 | Packing Gland | C63000/B150 |
| 3 | Upper stem | 316 SS/A479 |
| 4 | Lower Stem | 17-4PH/A564 |
| 5 | Packing Ring | C63000/B150 |
| 6 | Packing | PTFE/RPTFE |
| 7 | Packing washer | 17-4PH/A564 |
| 8 | Body | 316 SS/A479 |
| | Lubricant | Molybdenum disulfide |

Note:

- Special materials available on request. For the materials not shown above, please contact the authorized representative or FITOK Group.

Dimensions

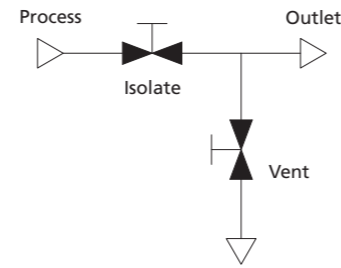
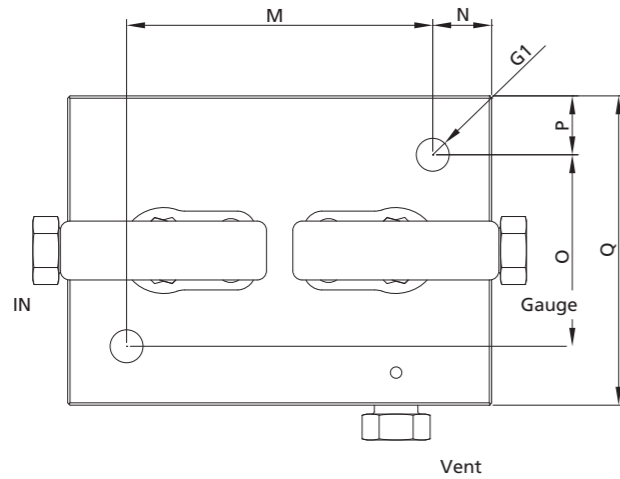
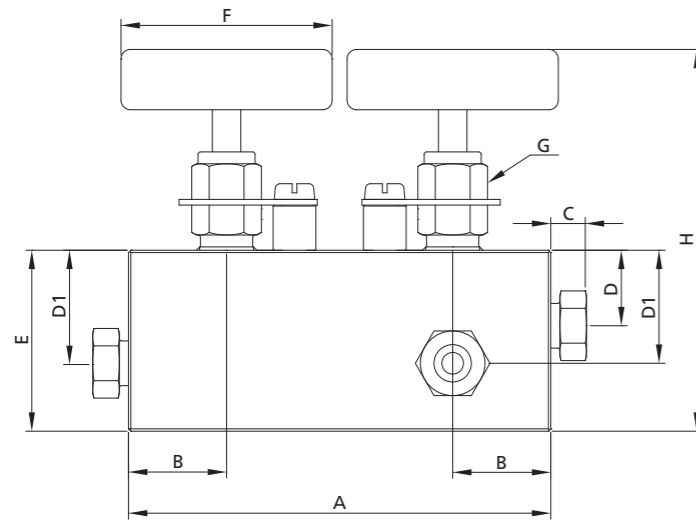

| Dimensions | | | | | | | | | | | | | | | | | |
|-----------------|-------------------------|------------------|-------------|-------------|-------------|-------------|-------------|-------------|-------------|-------------|-------------|-------------|-------------|-------------|-------------|-------------|-------------|
| Ordering Number | Connection Type (Inlet) | Orifice in. (mm) | A | B | C | D | D1 | E | F | G | G1 | H | M | N | O | P | Q |
| | | | in. (mm) | | | | | | | | | | | | | | |
| 15BNSS-FNS4 | FNS4 | 0.094 (2.4) | 3.78 (96.0) | 1.00 (25.4) | 0.81 (20.6) | 1.08 (27.5) | 1.50 (38.1) | 1.75 (44.5) | 0.50 (12.7) | 0.28 (7.1) | 3.26 (82.7) | 2.74 (69.5) | 0.37 (9.5) | 1.25 (31.8) | 0.37 (9.5) | 2.00 (50.8) | |
| 15BNSS-FNS6 | FNS6 | 0.094 (2.4) | 3.78 (96.0) | 1.00 (25.4) | 0.81 (20.6) | 1.08 (27.5) | 1.50 (38.1) | 1.75 (44.5) | 0.50 (12.7) | 0.28 (7.1) | 3.26 (82.7) | 3.50 (89.1) | 0.37 (9.5) | 1.25 (31.8) | 0.37 (9.5) | 2.00 (50.8) | |
| 20BNSS-2FH4 | 2FH4 | 0.094 (2.4) | 3.5 (88.9) | 0.81 (20.6) | 0.38 (9.7) | 0.81 (20.6) | 1.08 (27.5) | 1.50 (38.1) | 1.75 (44.5) | 0.50 (12.7) | 0.28 (7.1) | 3.26 (82.7) | 2.74 (69.5) | 0.37 (9.5) | 1.25 (31.8) | 0.37 (9.5) | 2.00 (50.8) |
| 20BNSS-2FH6 | 2FH6 | 0.094 (2.4) | 3.88 (98.5) | 1.00 (25.4) | 0.44 (11.1) | 0.81 (20.6) | 1.08 (27.5) | 1.50 (38.1) | 1.75 (44.5) | 0.50 (12.7) | 0.28 (7.1) | 3.26 (82.7) | 3.50 (89.1) | 0.37 (9.5) | 1.25 (31.8) | 0.37 (9.5) | 2.00 (50.8) |

- Note:
- G is the drill dimension of packing gland mounting hole.
 - G1 is the panel mounting drill size.
 - H is the dimension of stem in closed position.
 - All dimensions are for reference only and are subject to change. For dimensions not shown above, please contact the authorized representative or FITOK Group.

Part Number Description

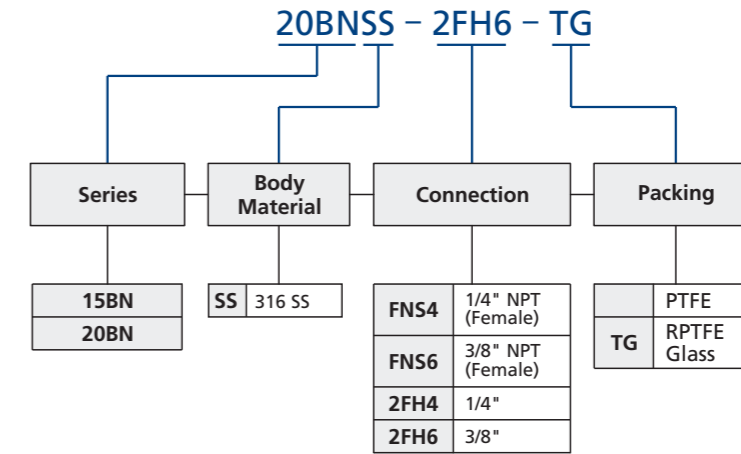

Note: "Part Number Description" is used for composition rules of FITOK product model, Not suitable for specific product part number selection, not random combinations. If in doubt, please contact FITOK group or authorized agent.

Double Block & Bleed Needle Valves

Pressures to 20,000 psi (1379 bar)

Features

- Compact design provides large valve performance in a small package.
- Reduced potential for leakage.
- Metal-to-metal seating achieves ideal shutoff, longer stem/seat service lifetime for abrasive flow, excellent corrosion resistance and greater durability for repeated on/off cycles.
- The material of packing gland and upper stem have been selected to achieve reduced handle torque and extended thread cycle life.
- The location of packing is under the thread of valve stem.
- The locking device of packing gland is reliable.
- Wide selection of tube and pipe end fittings available.

Flow Data at 100°F (38°C)

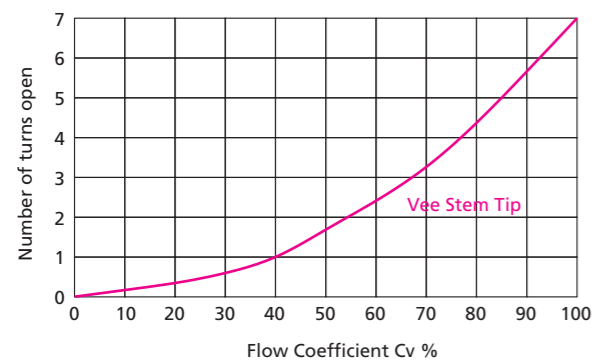

Pressure & Temperature

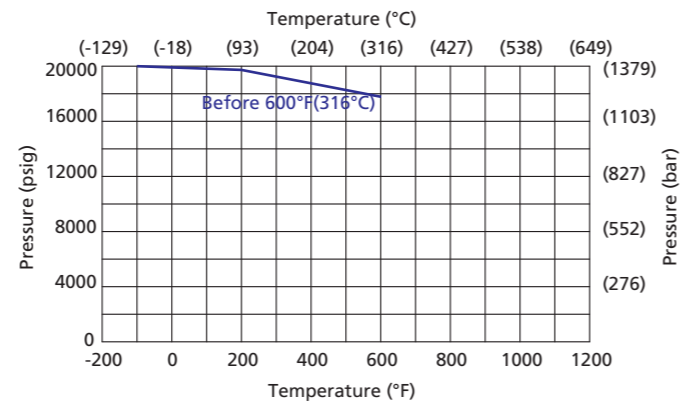

Technical Data

| Series | Connection Type | Vent Connection | Orifice in. (mm) | Rated Cv | Pressure @ Room Temperature psig (bar) |
|--------|-----------------|-----------------|------------------|----------|----------------------------------------|
| 20DBN | 2FH4 | 2FH4 | 0.093 (2.36) | 0.10 | 20,000 (1379) |
| | 2FH6 | 2FH4 | 0.093 (2.36) | 0.27 | 20,000 (1379) |
| | 2FH9 | 2FH4 | 0.093 (2.36) | 0.27 | 20,000 (1379) |
| | 6FH9 | 2FH4 | 0.093 (2.36) | 0.27 | 20,000 (1379) |

Note:

- Extreme Temperatures**
PTFE is the standard packing material for FITOK Needle Valve; RPTFE glass also available.
Normal Needle Valve with PTFE packing can be operated to 450°F (232°C).
Normal Needle Valve with RPTFE glass packing can be operated to 600°F (316°C).
- A variety of end connections available on request. For dimensions not shown above, please contact the authorized representative or FITOK Group.

Standard Materials of Construction

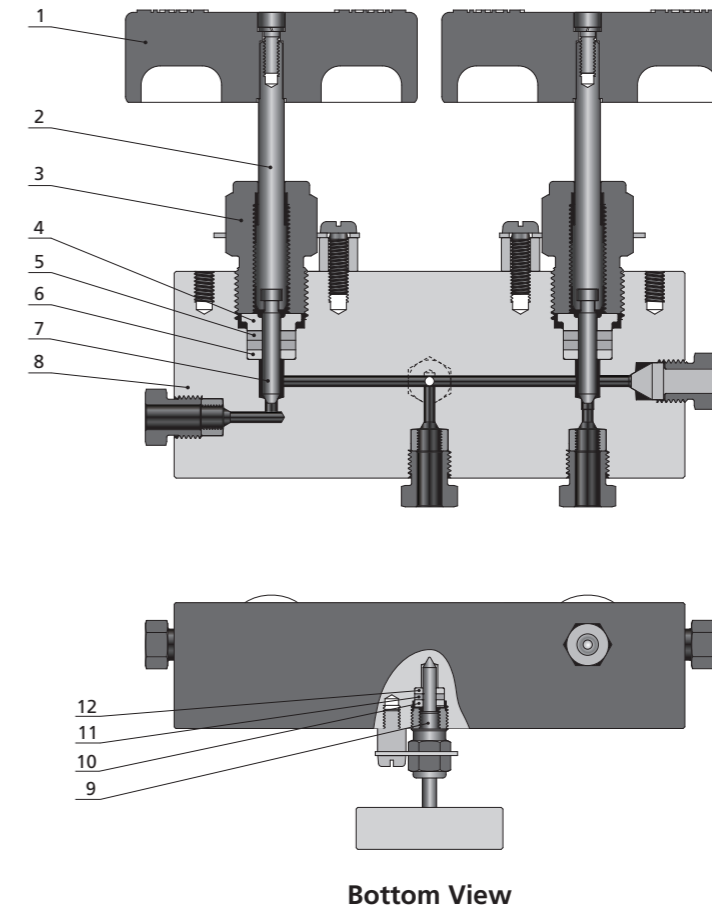

| Item | Component | Material Grade/ASTM Specification |
|------|---------------------------|-----------------------------------|
| 1 | Handle | Stainless steel |
| 2 | Upper stem | 316 SS/A479 |
| 3 | Packing Gland | C63000/B150 |
| 4 | Lower Stem | 17-4PH/A564 |
| 5 | Packing Ring | C63000/B150 |
| 6 | Packing | PTFE/RPTFE |
| 7 | Packing washer | 17-4PH/A564 |
| 8 | Body | 316 SS/A479 |
| 9 | Vent valve stem | 17-4PH/A564 |
| 10 | Vent valve Ring | C63000/B150 |
| 11 | Vent valve Packing | PTFE/RPTFE |
| 12 | Vent valve Packing washer | 17-4PH/A564 |
| | Lubricant | Molybdenum disulfide |

Note:

- 1. Special materials available on request. For the materials not shown above, please contact the authorized representative or FITOK Group.

Dimensions

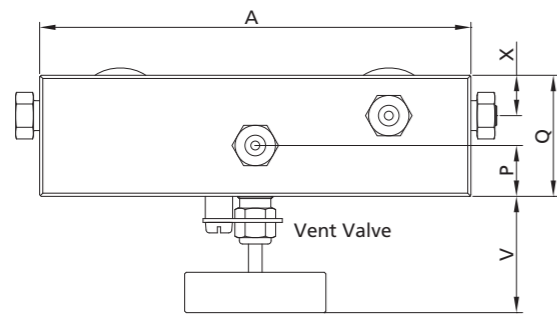
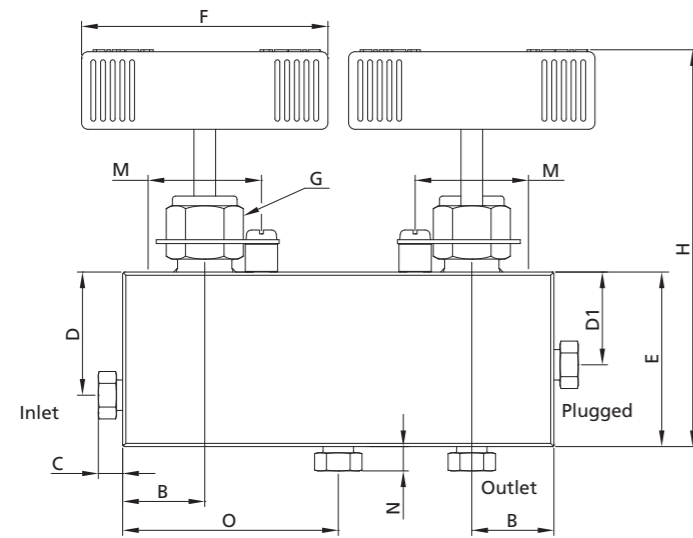

Bottom View

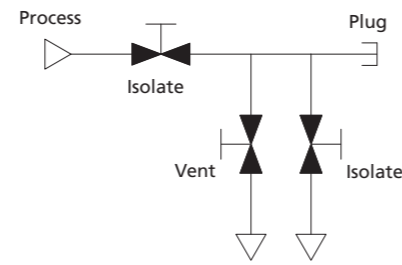

Part Number Description

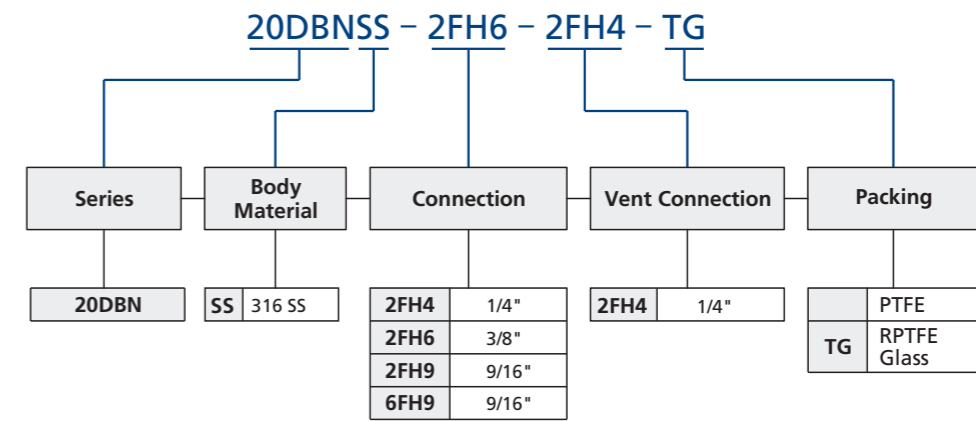

Note: "Part Number Description" is used for composition rules of FITOK product model, Not suitable for specific product part number selection, not random combinations. If in doubt, please contact FITOK group or authorized agent.

| Dimensions | | | | | | | | | | | | | | | | | | |
|-------------------|-----------------|------------------|--------------|-------------|-------------|-------------|-------------|-------------|-------------|-------------|--------------|-------------|-------------|-------------|-------------|-------------|-------------|-------------|
| Ordering Number | Connection Type | Orifice in. (mm) | A | B | C | D | D1 | E | F | G | H | M | N | O | P | Q | V | X |
| | | | in. (mm) | | | | | | | | | | | | | | | |
| 20DBNSS-2FH4-2FH4 | 2FH4 | 0.094 (2.4) | 5.25 (133.4) | 1.00 (25.4) | 0.38 (9.65) | 1.50 (38.1) | 1.13 (28.7) | 2.13 (54.1) | 3.00 (76.2) | 0.81 (20.6) | 4.65 (118.1) | 0.69 (17.5) | 0.50 (12.7) | 2.62 (66.7) | 0.63 (16.0) | 1.50 (38.1) | 1.43 (36.3) | 0.50 (12.7) |
| 20DBNSS-2FH6-2FH4 | 2FH6 | 0.094 (2.4) | 5.25 (133.4) | 1.00 (25.4) | 0.44 (11.2) | 1.50 (38.1) | 1.13 (28.7) | 2.13 (54.1) | 3.00 (76.2) | 0.81 (20.6) | 4.65 (118.1) | 0.69 (17.5) | 0.50 (12.7) | 2.62 (66.7) | 0.63 (16.0) | 1.50 (38.1) | 1.43 (36.3) | 0.50 (12.7) |
| 20DBNSS-2FH9-2FH4 | 2FH9 | 0.094 (2.4) | 5.88 (149.4) | 1.31 (33.3) | 0.55 (14.0) | 1.50 (38.1) | 1.13 (28.7) | 3.00 (76.2) | 3.00 (76.2) | 0.81 (20.6) | 5.53 (140.5) | 0.69 (17.5) | 0.50 (12.7) | 2.94 (74.7) | 0.63 (16.0) | 1.75 (44.5) | 1.43 (36.3) | 0.75 (19.1) |
| 20DBNSS-6FH9-2FH4 | 6FH9 | 0.094 (2.4) | 5.88 (149.4) | 1.31 (33.3) | 0.95 (24.1) | 1.50 (38.1) | 1.13 (28.7) | 3.00 (76.2) | 3.00 (76.2) | 0.81 (20.6) | 5.53 (140.5) | 0.69 (17.5) | 0.50 (12.7) | 2.94 (74.7) | 0.63 (16.0) | 1.75 (44.5) | 1.43 (36.3) | 0.75 (19.1) |

- Note:
- G is the drill dimension of packing gland mounting hole.
 - G1 is the panel mounting drill size.
 - H is the dimension of stem in closed position.
 - All dimensions are for reference only and are subject to change. For dimensions not shown above, please contact the authorized representative or FITOK Group.

Double Block & Bleed Ball Valves

Pressures to 15,000 psi (1034 bar)

Features

- One-piece, trunnion mounted style, ideal for severe duty applications.
- Carbon filled PEEK seats offer excellent resistance to chemicals, heat, and wear/abrasion.
- Vee-stem vent valve.
- Full-port flow path minimizes pressure drop.
- 316 cold worked stainless steel construction.
- Fluorocarbon FKM O-rings for operation from 0°F to 400°F (-17.8°C to 204°C).
- Wide selection of O-rings available.
- Wide selection of tube and pipe end fittings available.
- Quarter turn from open to close with positive stop.

Pressure & Temperature Curve

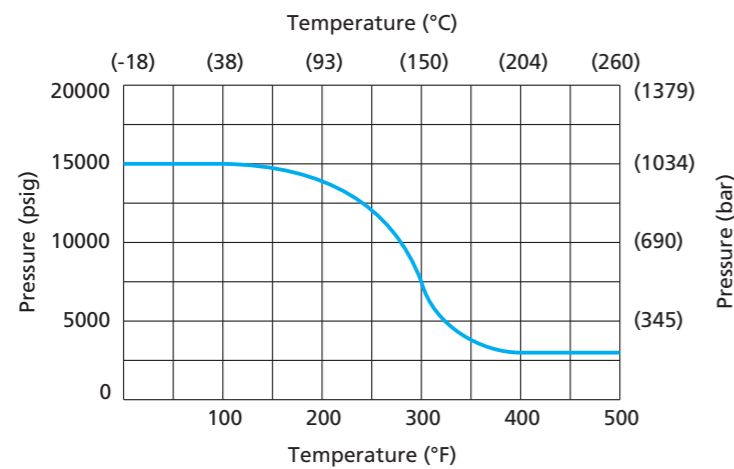

NOTE: Ball valves are not recommended for critical gas applications such as Hydrogen, Helium or other small molecular gases.

Standard Materials of Construction

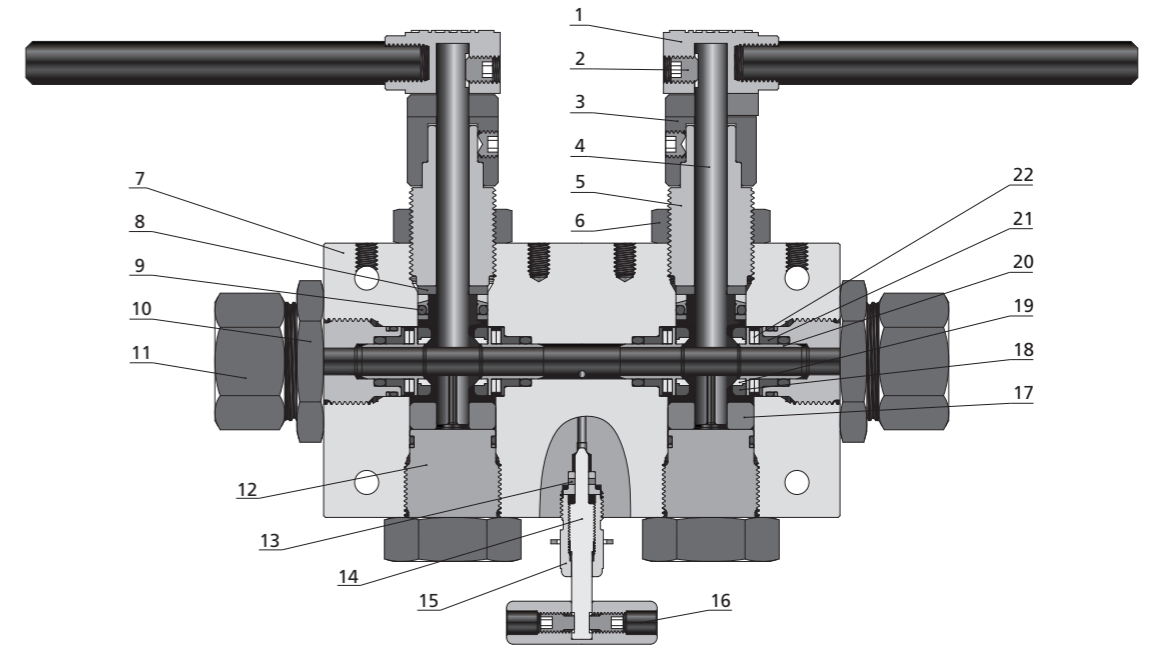

| Item | Component | Valve Material |
|------|--------------------------|----------------------------------------|
| 1 | Handle | Stainless Steel |
| 2 | Set Screw | Stainless Steel |
| 3 | Stopping Device | 316 SS/A276 |
| 4 | Ball Stem | 316 SS/A479 |
| 5 | Packing Gland | 316 SS/A479 |
| 6 | Locking Piece | 316 SS/A276 |
| 7 | Valve Body | 316 SS/A479 |
| 8 | Thrust Washer | C63000/B150 |
| 9 | Combination Seal | Fluorocarbon FKM |
| 10 | Lock Nut | 316 SS/A276 |
| 11 | Seat Gland | 316 SS/A479 |
| 12 | Botton Gland | 316 SS/A479 |
| 13 | Vent Valve Packing | PTFE |
| 14 | Vent Valve Stem | 17-4PH/A564 |
| 15 | Vent Valve Packing Gland | C63000/B150 |
| 16 | Vent Valve Handle | Stainless Steel |
| 17 | Bearing | PEEK |
| 18 | Seat Retainer | S17400/A564 |
| 19 | Seat | Carbon Filled PEEK |
| 20 | Support | 316 SS/A479 |
| 21 | Belleville Backup | S17400/A564 |
| 22 | Belleville Washers | 17-7PH/A693 |
| | Lubricant | Molybdenum Disulfide/Fluorinated-based |

Dimensions

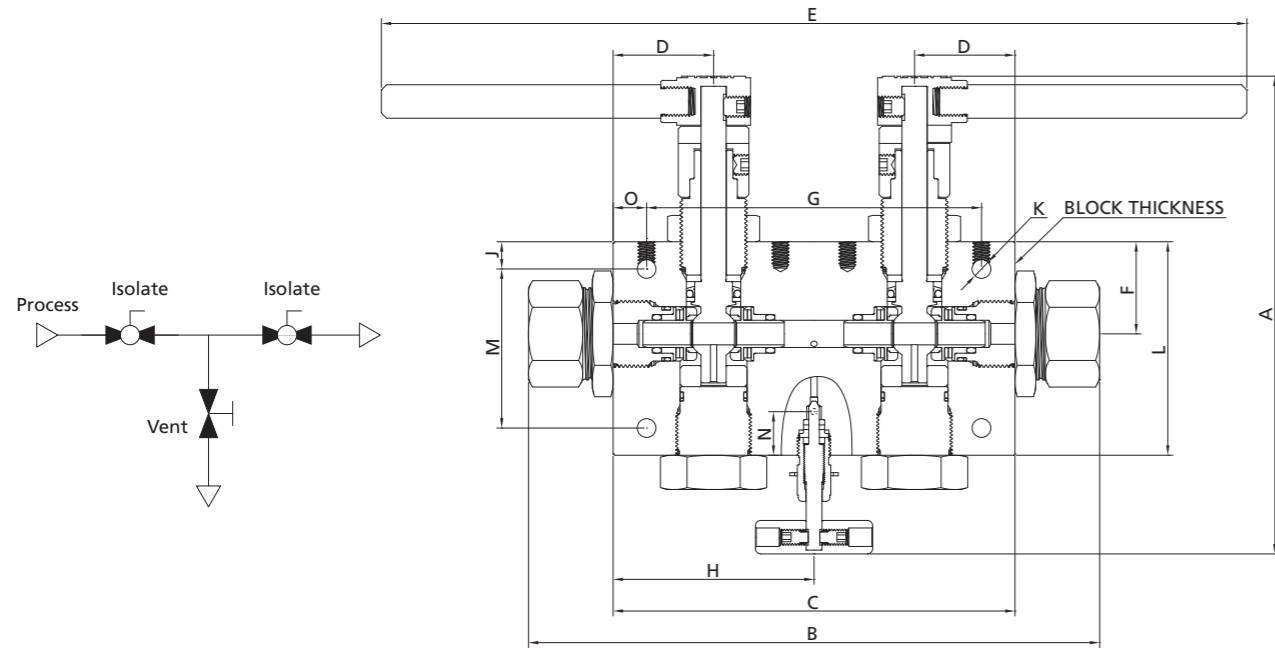

| A | B | C | D | E | F | G | H | J | K | L | M | N ^① | O | Block Thickness |
|-----------------|-----------------|--------------|---------------|------------------|----------------|------------|-------------|----------------|---------------|--------------|----------------|----------------|---------------|-----------------|
| in. (mm) | | | | | | | | | | | | | | |
| 7.14 (181.4) | 8.81 (223.8) | 6 (152.4) | 1.5 (38.1) | 12.94 (328.7) | 1.38 (34.9) | 5 (127) | 3 (76.2) | 0.41 (10.3) | 0.28 (7.1) | 3.19 (81) | 2.38 (60.4) | 0.65 (16.5) | 0.5 (12.7) | 1.75 (44.45) |

① N: Vent connection on back side.

Panel Mounting Dimensions

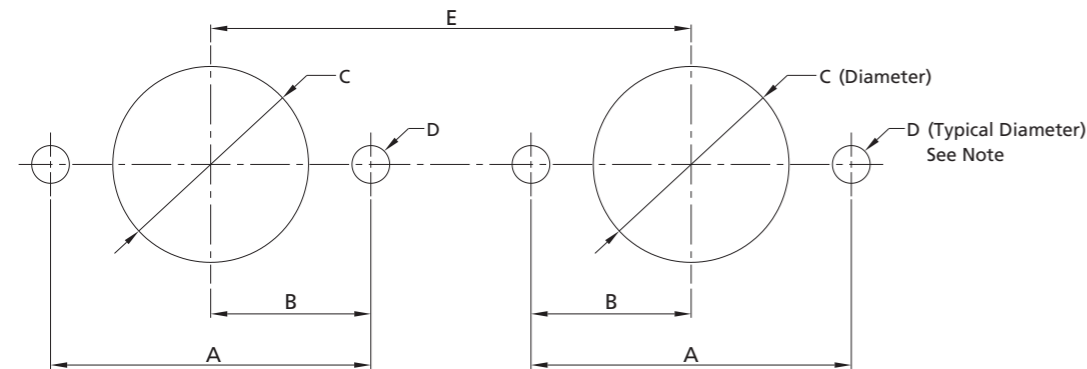

All dimensions are for reference only and are subject to change.

| A | B | C | D | E |
|-------------|-------------|---------------|---------------|-------------|
| in. (mm) | in. (mm) | in. (mm) | in. (mm) | in. (mm) |
| 2 (50.8) | 1 (25.4) | 1.5 (38.1) | 0.28 (7.1) | 3 (76.2) |

Note: Body mounting 1/4-20 thread

Part Number Description

| Series | Connection | Vent Connection | Orifice No. | Orifice Size in. (mm) | Rated Cv | Catalog No. | Pressure/Temperature Rating psig (bar) @ Room Temperature |
|--------|------------|-----------------|-------------|-----------------------|----------|----------------------|-----------------------------------------------------------|
| 15DBB | FH8 | FNS4 | 6 | 0.33 (8.3) | 2.3 | 15DBBSS-FH8-FNS4-6 | 15,000 (1034) |
| | 2FH4 | 2FH4 | | 0.20 (5.2) | 0.9 | 15DBBSS-2FH4-2FH4-6 | |
| | 2FH6 | 2FH4 | | 0.30 (7.9) | 2.1 | 15DBBSS-2FH6-2FH4-6 | |
| | 2FH9 | 2FH4 | | 0.33 (8.3) | 2.3 | 15DBBSS-2FH9-2FH4-6 | |
| | 2FH9 | FNS4 | | 0.33 (8.3) | 2.3 | 15DBBSS-2FH9-FNS4-6 | |
| | 2FH12 | 2FH4 | | 0.33 (8.3) | 2.3 | 15DBBSS-2FH12-2FH4-6 | |
| | 2FH16 | FNS4 | | 0.33 (8.3) | 2.3 | 15DBBSS-2FH16-FNS4-6 | |
| | FNS4 | FNS4 | | 0.33 (8.3) | 2.3 | 15DBBSS-FNS4-FNS4-6 | |
| | FNS6 | FNS4 | | 0.33 (8.3) | 2.3 | 15DBBSS-FNS6-FNS4-6 | |
| FNS8 | FNS4 | 0.33 (8.3) | 2.3 | 15DBBSS-FNS8-FNS4-6 | | | |

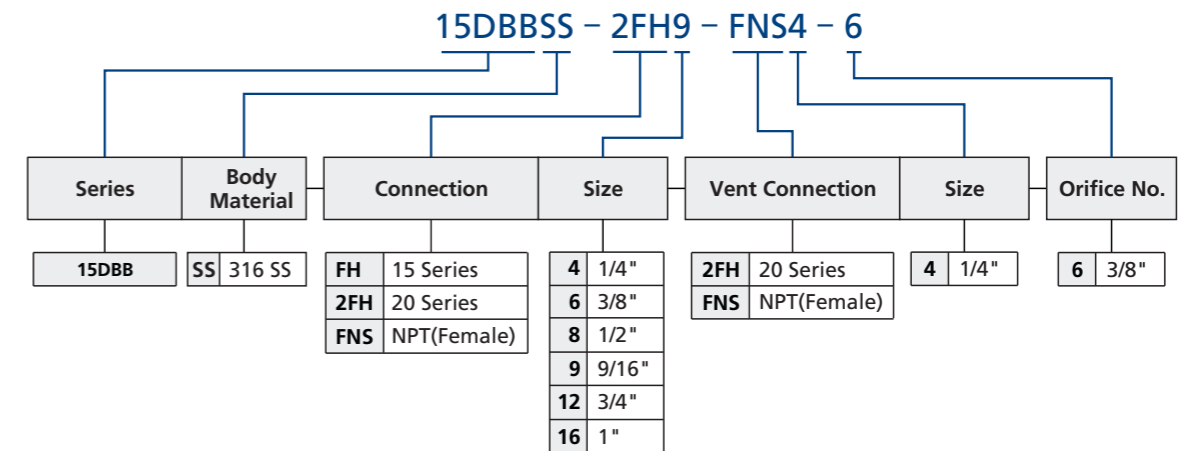

Options: O-ring
 Fluorocarbon FKM is standard. For other materials, add a material code to the valve ordering number.
 Example: 15DBBSS-2FH9-FNS4-6-N

| Code | O-ring Material | Temperature Range |
|------|------------------|-----------------------------|
| | Fluorocarbon FKM | 0 to 400°F (-17.8 to 204°C) |
| N | NBR | -40 to 250°F (-40 to 121°C) |
| F | FFKM | -40 to 500°F (-40 to 260°C) |
| E | EPDM | -50 to 300°F (-45 to 148°C) |

Note: "Part Number Description" is used for composition rules of FITOK product model, not suitable for specific product part number selection, not random combinations. If in doubt, please contact FITOK group or authorized agent.