

CHECK VALVES



C1 Series

- ◆ Working pressure up to: 3000 psig (207 bar)
- ◆ Working temperature: -10°F to 400°F (-23°C to 204°C)
- ◆ Opening pressure: 1/3 to 25 psig (0.02 to 1.7 bar)
- ◆ Variety of end connections and materials available
- ◆ End connections: 1/8" to 1" thread

- 1/8" to 1" Tube Fitting
- 3mm to 25mm Tube Fitting
- 1/4" to 1" VCR Fitting

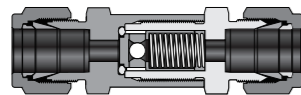

C2 Series

- ◆ Working pressure up to: 3000 psig (207 bar)
- ◆ Working temperature: -10°F to 400°F (-23°C to 204°C)
- ◆ Opening pressure: 1/3 to 25 psig (0.02 to 1.7 bar)
- ◆ Variety of end connections and materials available
- ◆ Compact design, one piece body
- ◆ End connections: 1/4" to 1/2" thread

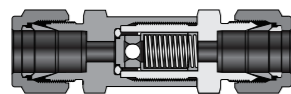

C3/CH Series

- ◆ Working pressure up to: 6000 psig (414 bar)
- ◆ Working temperature: -10°F to 400°F (-23°C to 204°C)
- ◆ Opening pressure: 1/3 to 25 psig (0.02 to 1.7 bar)
- ◆ Variety of end connections and materials available
- ◆ Apply to liquids or gases
- ◆ End connections: 1/8" to 1" thread

- 1/4" to 1" Tube Fitting
- 6mm to 25mm Tube Fitting
- 1/4" to 1" VCR Fitting

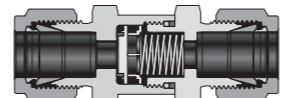

C3 Series

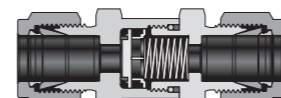

CH Series

C4 Series

- ◆ Working pressure up to: 3000 psig (207 bar)
- ◆ Working temperature: -10°F to 400°F (-23°C to 204°C)
- ◆ Opening pressure: 3 to 600 psig (0.2 to 41.4 bar)
- ◆ Variety of end connections and materials available
- ◆ End connections: 1/4" to 3/8" thread

- 1/4" to 1" Tube Fitting
- 6mm to 12mm Tube Fitting
- 1/4"至 1" VCR Fitting

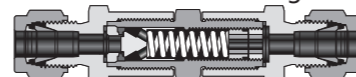

C5 Series

- ◆ Working pressure up to: 3000 psig (207 bar)
- ◆ Working temperature: -10°F to 400°F (-23°C to 204°C)
- ◆ Opening pressure: 3 to 600 psig (0.2 to 41.4 bar)
- ◆ Variety of end connections and materials available
- ◆ Compact design, one piece body
- ◆ End connections: 1/4" to 1/2" NPT thread

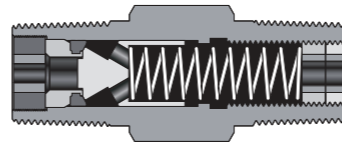

C6 Series

- ◆ Internally threadless and all-welded design
- ◆ Forward flow starts at less than 2 psig (0.14 bar) pressure differential
- ◆ Standard surface roughness finished to an average of Ra 20 yin. (0.51 ym) or electropolished to Ra 10 pin. (0.25 ym) optional
- ◆ Variety of end connections available
- ◆ Working temperature: -10~400°F (-23~204°C)
- ◆ Flow coefficient: 0.55 or 0.70
- ◆ Connections: 1/4" to 1/2" or 6 mm to 12 mm

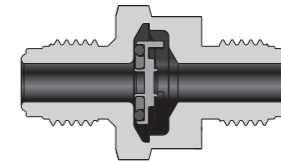

Ordering Number Description

A B C D E F G H I J
SS - C1 - 1 - F 8 - N 8 - Z -S-W

A	Body Material	D	P1 Type	E	P1 Size	F G	P2 Size
	SS=316 SS		M=Metric Ferrule		2=1/8"		Specify in the same way as the P1
	4S=304 SS		F=Fractional Ferrule		4=1/4"		
	21S=321 SS		FN=NPT female tapered threads		6=3/8"(6mm)		H Sealing Material
	904L=904L SS		N=NPT male tapered threads		8=1/2"(8mm)		
	6L=316L SS		FRT=ISO tapered female threads		10=5/8"(10mm)		Default=fluororubber (FKM)
	M=Alloy400		RT=ISO tapered male threads		12=3/4"(12mm)		B= Butyl rubber (NBR)
	B=Brass		FRP= Inch parallel female threads (suitable for RP gasket)		M12x 1.5		Z= Perfluorinated rubber (Kalrez)
			BP=ISO parallel male threads(suitable for RG gasket)		14=7/8"(14mm)		E= Ethylene-propylene rubber (EPDM)
			FMS=Metric female threads(suitable for RG gasket)		M14x1.5		I Special Application
			MS=Metric male threads (suitable for RG-M gasket)		M16x 1.5		
			TMS=Metric tube socket weld		20=1 1/4"(20mm)		Default = None
			TWS=Inch tube socket weld		M20x 1.5		S=NACE MR 0175
			TMB= Metric tube butt weld		22=22mm(M22x1.5)		J Cleaning and Packaging
			TWB=Inch tube butt weld		25=25mm		
			PWS=Pipe socket weld				Default = Standard cleaning and packaging for general industrial use
			PWB= Pipe butt weld				W=Degreasing
			UTB= nut +gasket+ metric tube union butt weld				W2=Oxygen-rich cleaning

B	Series
	C1 Series
	C2 Series
	C3/CH Series
	C4 Series
	C5 Series
	C6 Series

C	Opening pressure
	C1,C2,C3Series application:
	Default=3psig
	1/3=1/3psig
	1=1psig
	10=10psig
	25=25psig
	C4,C5Series application:
	Default=3-50psig
	60=50-150psig
	160=150-350psig
	360=350-600psig